

Trout Creek Homes & Cottages

By Trout Creek International Homes

Structural Insulated Panels | Pre-Built | Pre-Insulated | Pre-Packaged | Ready for Delivery | Easy Assembly



The River Springs

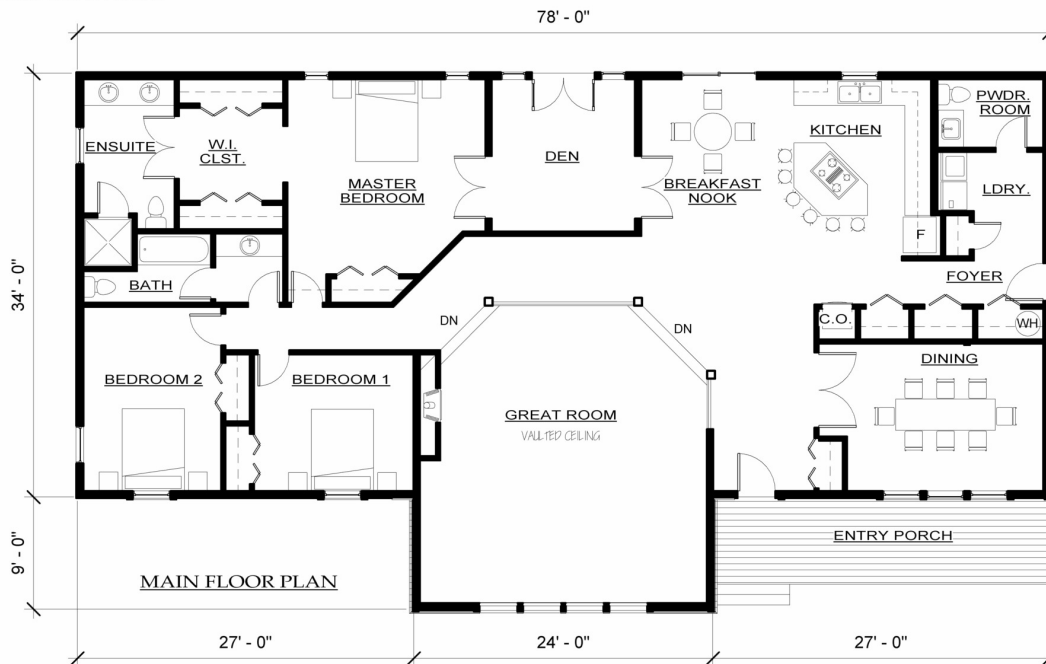

CABIN DESCRIPTION

78' x 34'
3 Bedroom
2+1 Bath
9' High Ceilings

WHAT'S INCLUDED

6" S.I.P. Walls
8" S.I.P. Roof (R 32) over Great Room
Engineered Subfloor
Timber Ridge Beam & Gable Accents
1" X 10" Beveled Cedar Siding
Douglas Fir Fascia
Construction Plans

OPTIONS

1" x 6" T&G for Vaulted Ceiling & Soffits
5" Wood Flooring
Wood Window / Door Trims